

## Installation Detail

If your proposed installation details differ from that shown here, please discuss this with the authority having jurisdiction, referencing this documentation.

Deviation from this drawing requires approval of the relevant authority.

Connecting ductwork omitted for clarity. Ductwork must be independently supported. There must be an appropriate break-away joint between the damper and the connecting ductwork on both sides of the installation.

A minimum of 200mm between fire dampers installed in separate ducts and 75mm between fire damper and construction elements/edges needs to be observed unless otherwise specified in the drawing.



**SCAN ME**

Please refer to the DoP for latest classifications for CE/UKCA compliance and the Installation, Operation and Maintenance Guide

E	ECN2227	MJB	29/04/22
D	ECN1830	RTC	20/03/18
C	EC1770	MJB	20-02-18
Rev:	Comments:	By:	Date:
Drawn By:	swehrle	Date:	22/07/2010
Checked By:	Kimberley.M	Date:	29/04/2022
Approved By:	Gore.S	Date:	29/04/2022

Description:  
**VERTICAL APPLICATION  
FIRE SHIELD & INSTALLATION  
FRAME IN MASONRY WALL**

Damper Size Range (mm)  
100 x 100 to 1250 x 1000

Reference No:	Sheet	Rev
AAF10703	1 of 1	E

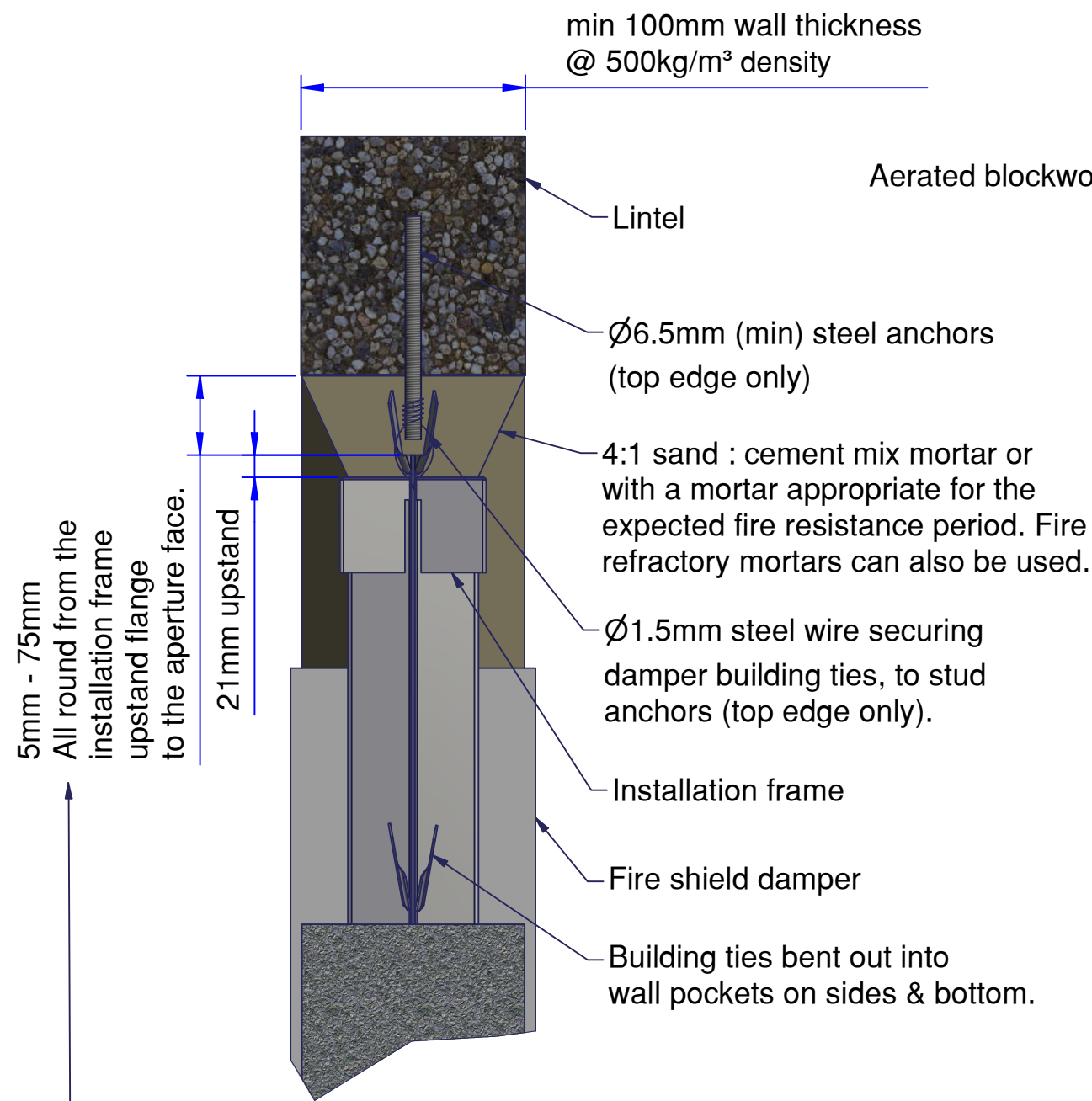

**VIEW A**  
(ALL ROUND DETAIL)

Note:  
Dimension is flexible;  
bear in mind building tie  
wall pockets dimensions.

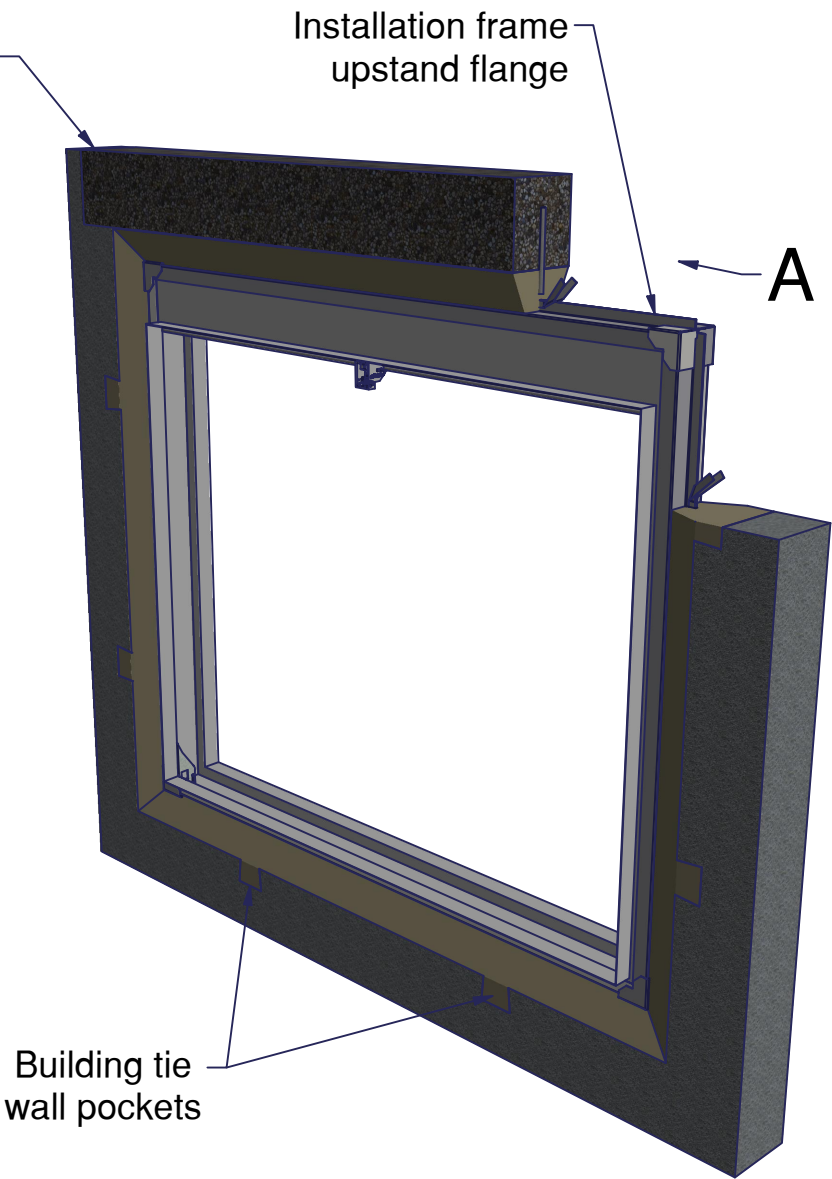
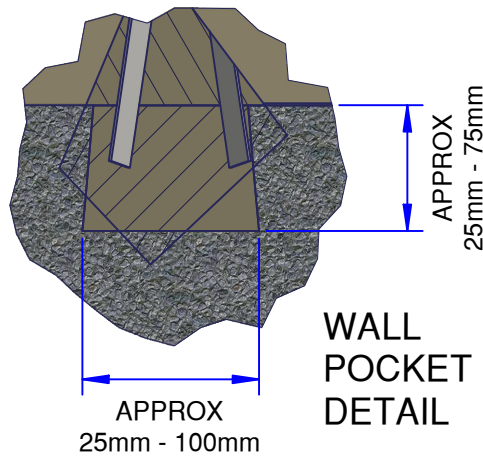

**NOTE:  
BUILDING TIE WALL  
POCKETS ON THE SIDES  
AND BOTTOM**

