

# WATERLOO EXPRESS CS-F 3 slot, 1500 length

Modular lengths for continuous or individual runs

## Quick Facts

- 75 l/s/m - 136 l/s/m on supply. Up to 188 l/s/m on extract.
- Can be configured for 1 way, 2 way or exhaust
- Hidden flow control for a consistent appearance
- 1500mm nominal length. 1528mm with 1 end cap. 1556mm with 2 end caps
- Low air pattern profile

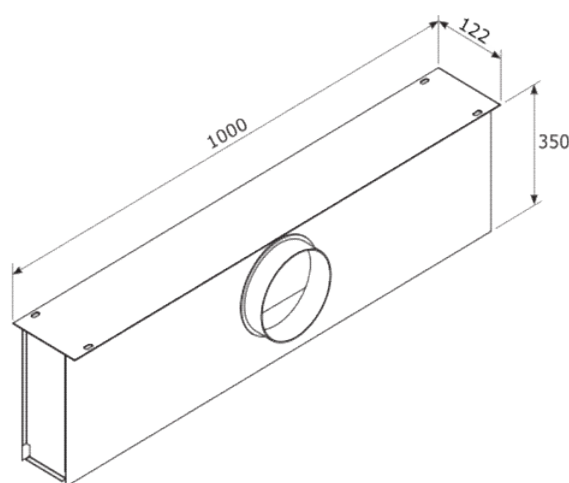
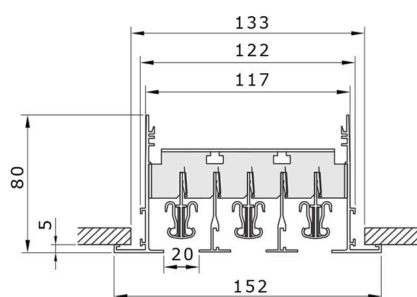
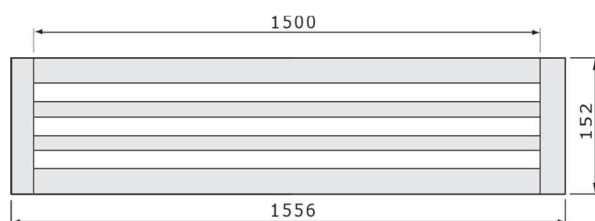

## Performance

	Supply						Extract	
Static Pressure	Air Volume	Throw (m)				Noise Level	Air Volume	Noise Level
		1 Way		2 Way Glazing / Open Plan Split				
Pa	l/s/m	Throw @ 0.5 m/s Vt	Throw @ 0.25 m/s Vt	Throw @ 0.5 m/s Vt	Throw @ 0.25 m/s Vt	NR	l/s/m	NR
5	75	2.8	4.2	1.6/2.3	2.4/3.4	<20	100	23
10	100	3.5	5.1	2.0/2.9	2.9/4.1	23	139	31
15	120	4.0	5.7	2.3/3.3	3.3/4.7	27	163	35
20	136	4.4	6.2	2.6/3.6	3.6/5.0	30	188	40

## Selection Example

Active length = Diffuser air volume divided by l/s/m for desired pressure.

For example, 425 l/s, 15 Pa max, on an CS 3 slot supply.

= 425 / 120 (from table)

Active length 3550 mm (rounded up to nearest 50mm)

Performance based on tabled volume (120 l/s/m), 4.0m throw 1 way @ Vt 0.5m/s, 15Pa, NR27

All performance is for guidance only.

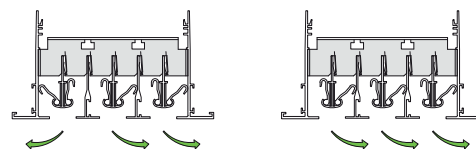

Product Group	Product description	EXPRESS Part Number	Price *
Linear Slot Diffuser	CS-F/1500/3SL/9010-Matt 20%/NO ENDS	EXP-CSF-001	£176.66
	CS-F/3SL/STANDARD END CAP/9010-Matt 20%	EXP-CSF-003	£3.00
Plenum	PBHL/CSF/1000/122/350/SE/250/ICC/FDC/Lined	EXP-PBHL-001	£100.19