

# EAGLE Wall c

Installation – Commissioning – Maintenance

20240712

## Accessories

### Commissioning box

#### ALV

The box is made of galvanised sheet steel and contains a removable commissioning damper, fixed measurement tapping and air distribution baffle. The commissioning box is available with two connection options: rear and side connection.

### Cover plate

#### ALVT 1

For a fitted and aesthetic installation of the ALV commissioning box.

## Installation

Installation and dismantling can be seen from figure 1.

1. Prepare an opening in the wall according to the dimensions specified in the dimension table.
2. Place the commissioning box containing the damper insert, air distribution plate and air distribution baffle in the opening.
3. Apply sealing compound between the commissioning box and the mounting frame to prevent air leakage. Insert the mounting frame into the commissioning box and secure it with screws in the short sides to the commissioning box and to the wall structure.
4. Press the diffuser face into the mounting frame.

## Commissioning

Commissioning must be carried out with the diffuser face mounted. Pull the measuring tube and the damper adjustment cords out of the air diffuser through a nozzle. Connect a manometer to the measuring tube. The desired commissioning pressure can be calculated using the rated coefficient of performance of the air diffuser. Set the damper to the correct blade position, tie a commissioning knot in the damper cords to indicate the damper position, then lock the cords.

The rated coefficient of performance (K-factor) is specified on the identification label of the product and in the relevant commissioning instructions at [www.swegon.com](http://www.swegon.com).

## Maintenance

The air diffuser can be cleaned, if necessary, using luke-warm water with dishwashing detergent added or by vacuum cleaning using a brush nozzle. The duct system can be accessed after the air diffuser section has been removed, the acoustic baffle has been withdrawn, the air distribution discs have been moved to the side and the damper has been turned and withdrawn from its fastener from the inlet. See Figure 1.

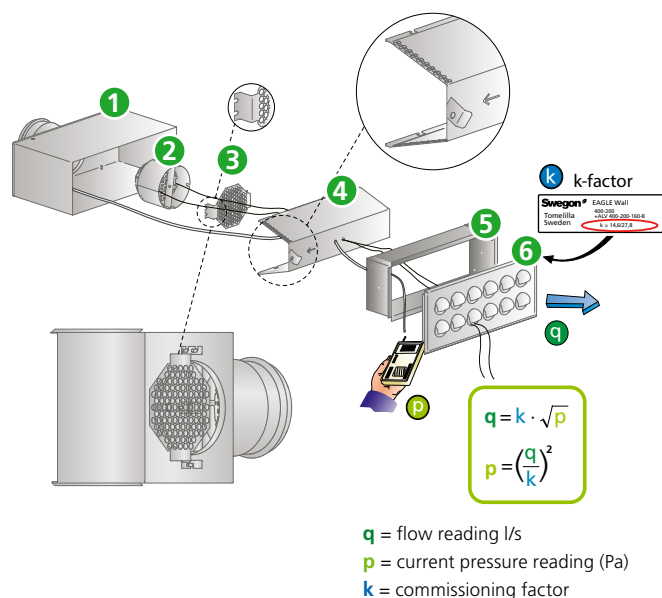

Figure 1. Installation, commissioning.

1. Commissioning box.
2. Damper insert, bayonet catch.
3. Octagonal air distribution plate, enlarged image shows the locking device.
4. Air distribution baffle, enlarged image shows the locking device.
5. Mounting frame.
6. Diffuser face.

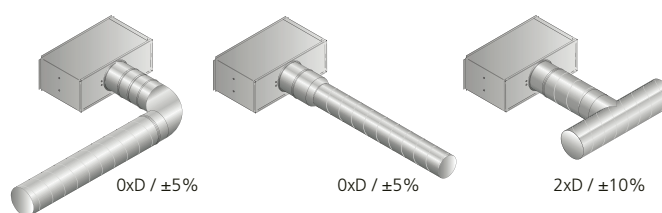

Figure 2. Installation options, applicable to all connections (B, K).

# Dimensions and weight

## EAGLE Wall and commissioning box ALV - rear connection

Size	Dimensions (mm)							Weight, diffuser (kg)	Weight, diffuser incl. ALV (kg)
	A	B	ØD	F	G	K	I x J		
300-150	330	180	99	295-375	225-305	70	305 x 155	0,7	3,1
400-150	430	180	124	295-375	225-305	70	405 x 155	0,9	3,9
400-200	430	230	159	315-395	225-305	90	405 x 205	1,0	4,5
550-250	580	280	199	360-440	251-331	110	555 x 255	1,5	6,5
550-300	580	330	249	385-465	251-331	134	555 x 305	1,6	7,5

Size of opening = I x J

CL = Centre line

## EAGLE Wall and commissioning box ALV - short side connection

Size	Dimensions (mm)								Weight, diffuser (kg)	Weight, diffuser incl. ALV (kg)
	A	B	ØD	G2	K	L	M	I x J		
300-150	330	180	99	270-350	77	145-225	195-275	305 x 155	0,7	3,3
400-150	430	180	124	331-411	77	180-260	240-320	405 x 155	0,9	4,4
400-200	430	230	159	331-411	95	145-225	225-305	405 x 205	1,0	5,0
550-250	580	280	199	371-451	114	145-225	245-325	555 x 255	1,5	7,4
550-300	580	330	249	425-505	138	145-225	275-355	555 x 305	1,6	8,7

Size of opening = I x J

CL = Centre line

### ALVT 1

Size	Dimensions (mm)		
	A	B	N
300-150	330	180	230
400-150	430	180	230
400-200	430	230	230
550-250	580	280	255
550-300	580	330	255

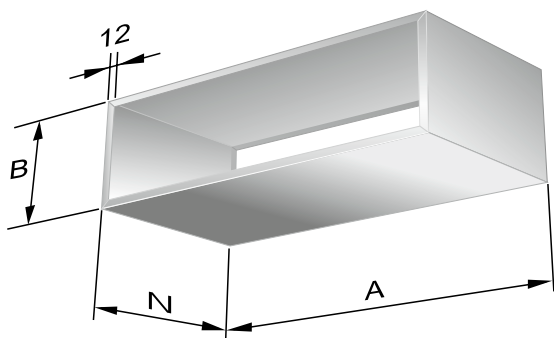

Figure 3. Cover plate ALVT 1.

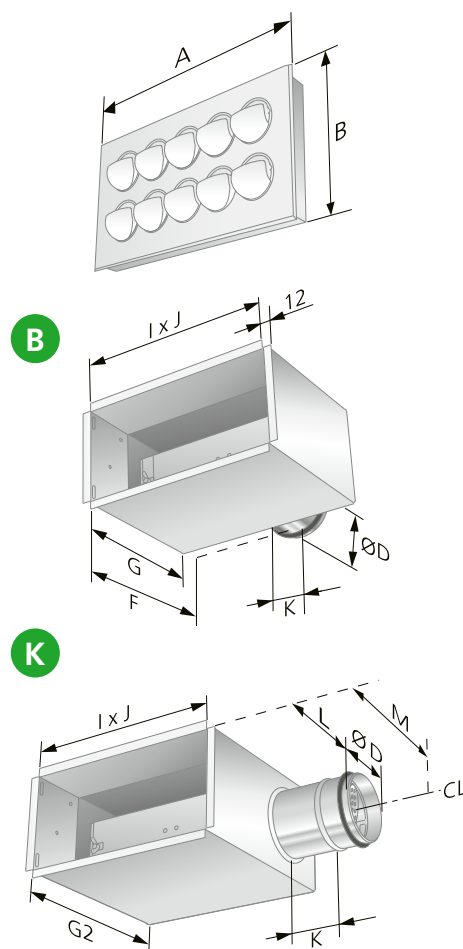

Figure 4. Dimensions, COLIBRI Wall and commissioning box ALV.

B = Rear connection.

K = Connection on short side.

CL = Centre line.

# Nozzle settings

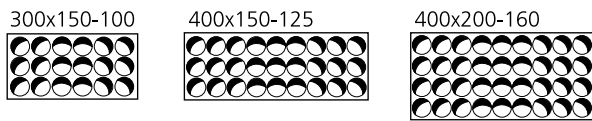

Figure 5. Standard nozzle settings, short throw length.

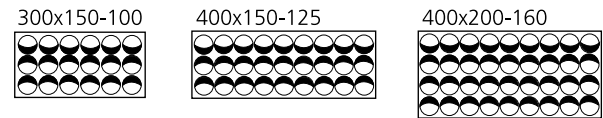
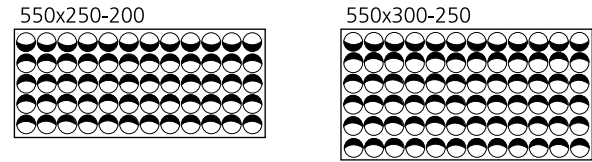
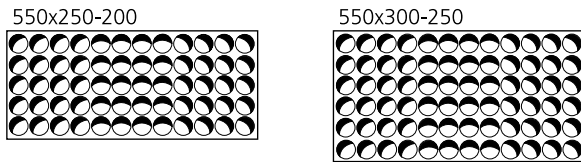

Figure 6. Nozzle settings, long throw length.



## K-factor

Size ALV	EAGLE Wall – supply air		
	Size	Connection – rear	Connection – short side
300-150-100	300-100	7,8	7,2
400-150-125	400-150	9,9	9,6
400-200-160	400-200	14,8	14,0
550-250-200	550-250	25,5	24,4
550-300-250	550-300	31,1	30,5